

# Early Years at Kirk Fenton



# Letter from the Headteacher

## Welcome to Kirk Fenton Church of England Primary School

Rooted in Christian belief, our vision for every member of this school community is to feel valued and respected, regardless of age, gender, sexuality, race, faith, belief or ability. Through developing a love of learning, each individual will have the opportunity to reach their full potential and aspire to become the person they were born to be.

We are a church school situated in the village of Church Fenton and a member of the STAR Multi Academy Trust. This is a group of local schools who have formed a Trust in order to provide high quality education to local children from 4 - 19 years in the Sherburn and Tadcaster area.

We have a happy school and are proud of our reputation for high expectations and an enthusiastic love of learning due to our broad and engaging curriculum. We take pride in the strong links that have been established with our village community and are keen to remain at its heart.

Our Christian values of **respect**, **thankfulness**, **perseverance** and **forgiveness** enable us to be committed to meeting the needs of every individual at our school. It is a privilege to share this period of your child's life with you and to work with families to enable our children to grow in independence and confidence, developing an awareness and understanding of wider moral, spiritual and cultural issues.

We are excited to warmly welcome you to our school community.

Mrs Karen Williams

Headteacher





# Our EYFS Team

---



Mrs Fitzpatrick  
EYFS & KS1 Leader



Miss Graham  
EYFS / Y1 Teaching Assistant



Mrs Peace  
EYFS Teaching Assistant



Mrs Skelton  
EYFS Teacher



Mrs Westfeld  
EYFS / Y1 Teacher



Mrs Young  
EYFS Teacher

# Curriculum

---

At Kirk Fenton C of E Primary School, the EYFS curriculum is designed to encourage independent, inquisitive and happy learners. We maximise activities which link different subjects in the curriculum, put reading at the heart of everything we do and support our children to build strong foundations for their future.

Children learn through a balance of child-initiated and adult-directed activities and challenges. The weekly timetable is carefully structured so that children have rigorous directed teaching in English, mathematics, phonics and reading every day.



Children are provided with plenty of time to engage in exploration and play throughout a variety of experiences, which are carefully planned to engage and challenge them, both inside and outside.

## A day in the life of an EYFS child at Kirk Fenton:

- A daily phonics session in the morning
- A daily math session in the afternoon
- A daily literacy activity
- A daily handwriting session
- A daily guided reading group
- A daily RE worship or discussion
- A whole class story
- Access to indoor and outdoor activities
- Access to snack and milk during freeflow activities



# Home School Communication

---

We share your child's learning with you through the Tapestry app. This will capture special moments, assessments and next steps. We welcome any photos and comments showing what your child has been doing at home. It's always wonderful to talk to them about any trips, visits or home learning.



The whole school also uses the Marvellous Me app. Children are awarded badges to celebrate their positive learning, values and behaviours. Teachers also use this app to share messages and reminders with parents.

Staff will be available on the door in the morning and at the end of the day should you need to share any important information. You will notice that school is different to private nursery in that we do not give individual debriefs each day. Rest assured, we will let you know if there is anything significant to report from your child's day. For longer or more personal conversations, we invite you to make an appointment. This can be made directly with the class teacher or through the school office.

Parent consultations take place in the autumn and spring term. This is an opportunity to discuss your child's wellbeing and progress. A written report will be sent home at the end of the year which summarises and describes your child's attainment against the EYFS learning goals. This is a statutory assessment.





# School Uniform

---

Children in EYFS come to school in their school uniform 3 days per week and their PE uniform 2 days per week. You may wish to adjust the uniform you buy to reflect this. In September, your class teacher will let you know the class' PE days and all children should come to school on their first day in their school uniform. A named water bottle should be sent in each day and a named bag of spare clothes may be sent and kept in school in case a change of clothes is needed.



## School Uniform:

- red sweatshirt / red cardigan (school badge available)
- white polo shirt (school badge available)
- black trousers / tailored shorts or black skirt / pinafore dress
- red tights or white socks with dress / skirt
- black socks with trousers / shorts
- black school shoes / black ankle boots (no heels)
- wellies to be left in school
- red or black hair accessories (hair bands, clips, bobbles)

## Summer School Uniform (Easter-July) only:

- red and white gingham summer dress

## PE Uniform:

- black shorts (school badge available)
- black joggers (school badge available)
- white crew neck t-shirt (school badge available)
- red hooded sweatshirt (school badge available)
- white sports socks
- black sports trainers

## Additional items:

- red school summer cap with school badge
- red school logo book bag
- red school jacket (school badge available)
- red winter hat with school badge

# School Map

On the first day our friendly staff will be located around the school site to welcome you and direct you to your child's classroom.

Our 2 EYFS classrooms are located on the right side of the school after entering along the school path. Please park considerately in the village.

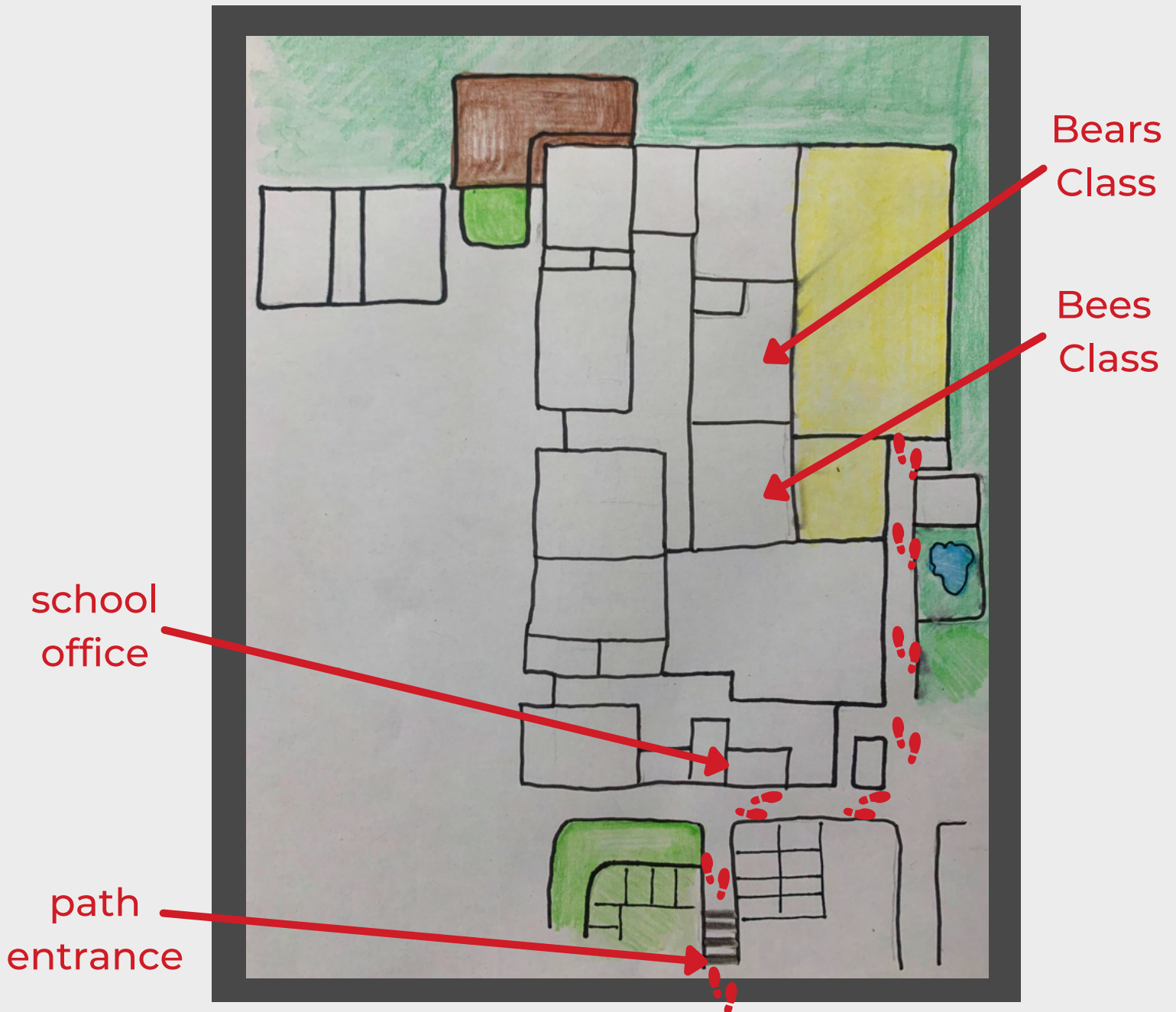

If you have any questions, no matter how big or small, prior to starting at Kirk Fenton, please pick up the phone or send us an email. We are more than happy to help!

**email:** [admin@kf.starmat.uk](mailto:admin@kf.starmat.uk)

**tel:** 01937 557228